

TWIN HELIX LEAD SECTION

C110-0227 (GALV)
C114-0020 (UNGALV)

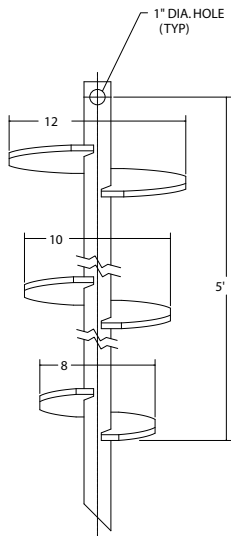

TRIPLE HELIX LEAD SECTION

C110-0235 (GALV)
C114-0021 (UNGALV)

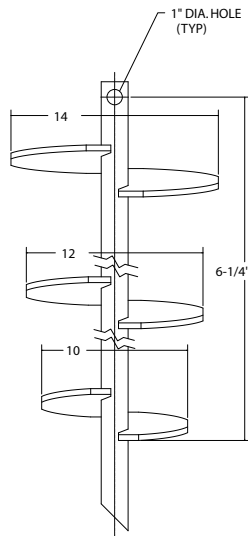

TRIPLE HELIX LEAD SECTION

T110-0674 (GALV)

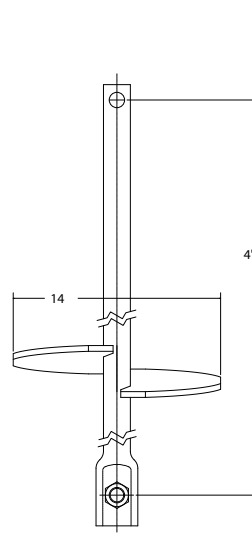

SINGLE HELIX EXTENSION

C110-0472 (GALV)
C114-0109 (UNGALV)

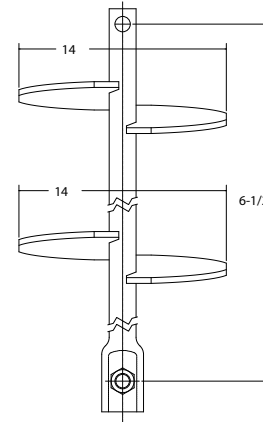

TWIN HELIX EXTENSION

C110-0450 (GALV)
C114-0057 (UNGALV)

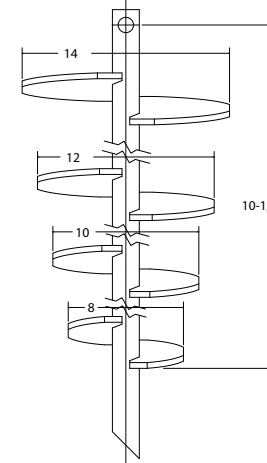

QUAD HELIX LEAD SECTION

C110-0247 (GALV)
C114-0101 (UNGALV)

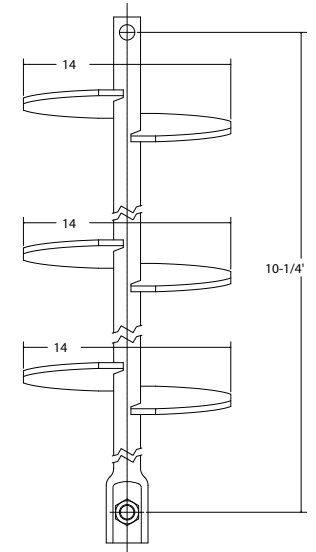

TRIPLE HELIX EXTENSION

C110-0476 (GALV)
C114-0113 (UNGALV)

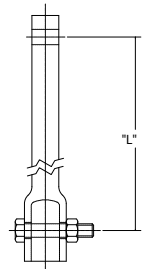

PLAIN EXTENSION

CAT. NO.	FINISH	"L" IN
C110-0136	GALV	37
C114-0022	UNGALV	37
C110-0137	GALV	59
C114-0105	UNGALV	59
C110-0138	GALV	80
C114-0023	UNGALV	80
C110-0140	GALV	124
C114-0081	UNGALV	124

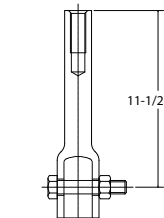

1" DYWIDAG BAR ADAPTER

C114-0010 (GALV)

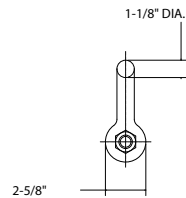

CHAIN SHACKLE

T110-0134 (GALV)

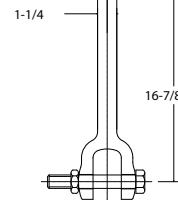
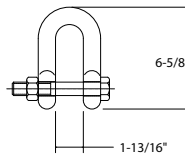

TRIPLEYE ADAPTER

T110-0465 (GALV)

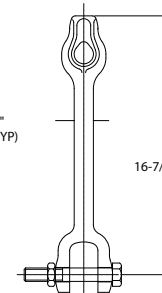

THIMBLEYE ADAPTER

T110-0311 (GALV)

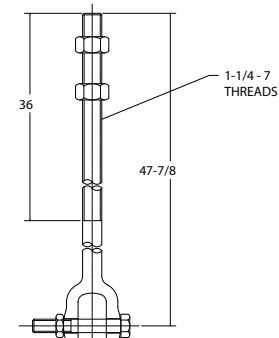

THREADED ADAPTER

T110-0352 (GALV)

-NOTES-

1. ITEMS MARKED "GALV" ARE HOT DIP GALVANIZED PER ASTM A153-(LATEST REV)
2. COUPLING BOLTS: 7/8" DIAMETER X 3-1/2" LONG HEX HEAD PER ASTM A193 GRADE B7.
3. ALLOWABLE TORQUE CAPACITY - 10,000 FT-LBS.
4. ULTIMATE CAPACITY FOR AXIALLY LOADED FOUNDATION (TENSION/COMPRESSION LOADS) - 100 KIPS.

REV	DATE	CHANGED BY	RESP ENGINEER
E	01-06-98	QUALLS	HOYT
<p style="text-align: center;">SS175 ANCHORS</p>			
JONES	01-22-91		
			SA110-10018