

LEAD SECTION
C110-0571 (UNGALV)

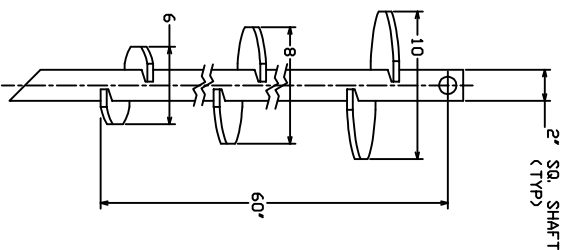

LEAD SECTION
C110-0569 (GALV)
C114-0214 (UNGALV)

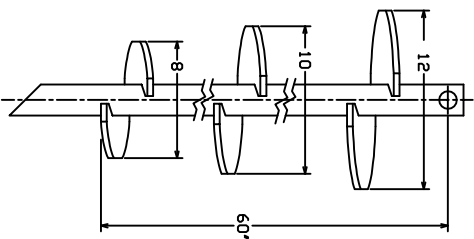

LEAD SECTION
C110-0570 (GALV)
C114-0215 (UNGALV)

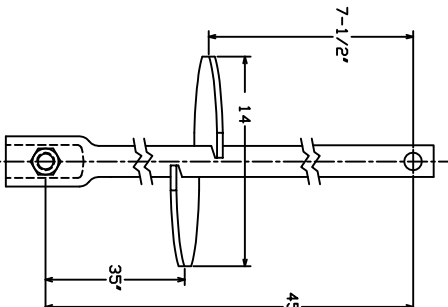

SINGLE HELIX
EXTENSION
C110-0577 (GALV)
C114-0220 (UNGALV)

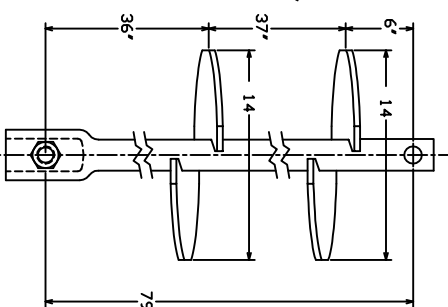

TWO HELIX
EXTENSION
C110-0581 (GALV)
C114-0224 (UNGALV)

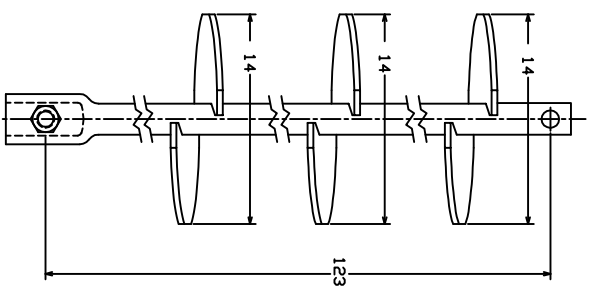

THREE HELIX
EXTENSION
C110-0586 (GALV)
C114-0231 (UNGALV)

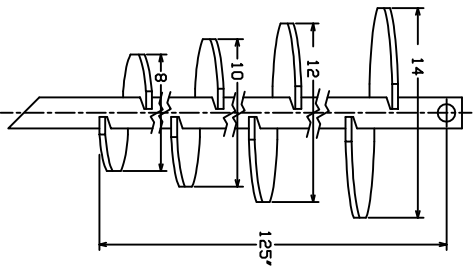

LEAD SECTION
C110-0573 (GALV)
C114-0217 (UNGALV)

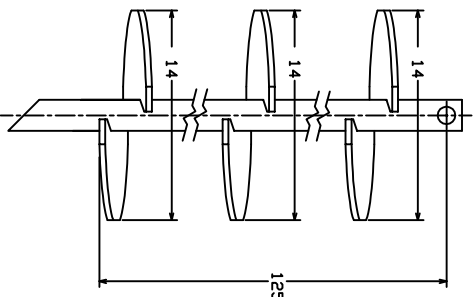

LEAD SECTION
C110-0572 (GALV)
C114-0216 (UNGALV)

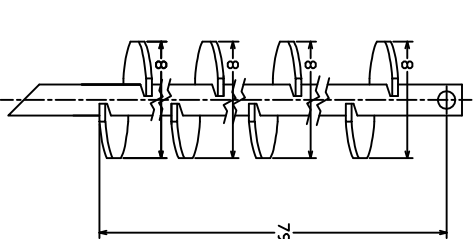

LEAD SECTION
C114-0218 (GALV)

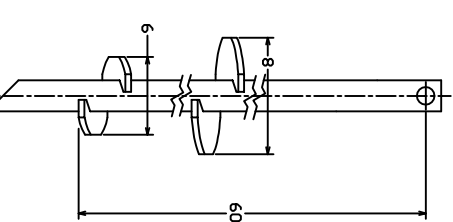

LEAD SECTION
C110-1155 (GALV)

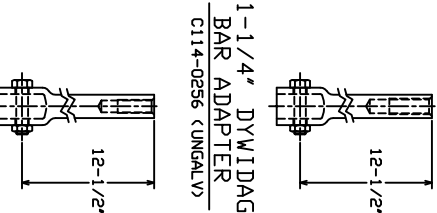

1" DYWIDAG
BAR ADAPTER
C114-0227 (GALV)

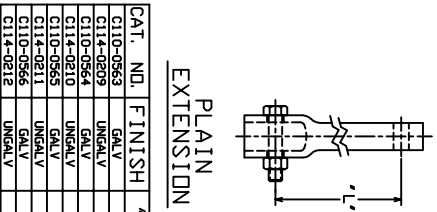

60° 1-1/4" DYWIDAG
BAR ADAPTER
C114-0256 (UNGALV)

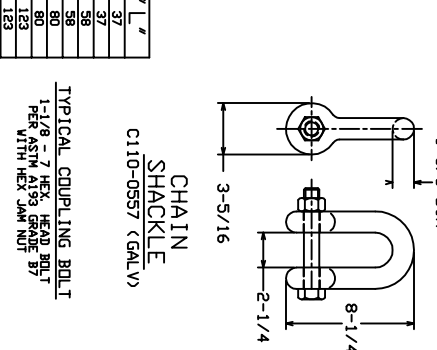

CHAIN
SHACKLE
C110-0557 (GALV)

CAT. NO.	FINISH	" L "
C110-0563	GALV	37
C114-0209	UNGALV	37
C110-0564	GALV	58
C114-0210	UNGALV	58
C110-0565	GALV	80
C114-0211	UNGALV	80
C110-0566	GALV	123
C114-0212	UNGALV	123

TYPICAL COUPLING BOLT
1-1/8" 7 HARSY HEAD BOLT
F155 ASTM A193 GRADE B7
WITH HEX JAM NUT

TORQUE STRENGTH RATING: 16,000 FT-LB
ULTIMATE CAPACITY *(TENSION/COMPRESSION) = 150KIPS
* BASED ON TORQUE FACTOR OF 10

CHANCE

CONFIDENTIAL: THIS DRAWING AND ITS CONTENTS ARE THE EXCLUSIVE PROPERTY OF HUBBELL POWER SYSTEMS. NO REPLICATION, STORAGE, OR DISSEMINATION OF THIS DRAWING OR ITS CONTENTS IS PERMITTED WITHOUT THE WRITTEN CONSENT OF HUBBELL POWER SYSTEMS. UNPUBLISHED OR RIGHTS RESERVED UNDER THE COPYRIGHT LAWS.

HUBBELL POWER SYSTEMS
SS200
ANCHORS

SIZE: DWG NO. S4110-10019
REV: H

DO NOT SCALE THIS DRAWING
OWN BY: BRACZAL DATE: 11/8/11 SHEET 1/1